



AVK SWING CHECK VALVE, PN10/16

41/60-003

Resilient seated, with free shaft end

AVK series 41 swing check valves come with both metal and resilient seats. Installed in pumping applications to prevent back flow they can be used for drinking water as well as waste water. The disc is connected to the shaft via a flexible bush that allows disc and valve seat to adjust exactly. All interior parts are stainless steel or coated with drinking water approved epoxy or EPDM. The series 41 valves are available with either closed bushings or protruding shaft end where a lever with a weight or a spring can be fitted to mitigate pressure surges.

Product description:

Swing check valve, resilient seated with free shaft end. For drinking water and neutral liquids to max. 70°C

Design standards:

- EN 1074-3
- Face-to-face dimension according to EN 558 Table 2 Basic Series 48
- Flange drilling to EN1092, PN10/16

Test/Approvals:

- Hydraulic test according to EN12050-4

Accessories:

Lever and weight, lever and spring, guard around lever and weight, combi-flanges, flange adaptors.



Expect ... **AVR**

Resilient seated, with free shaft end

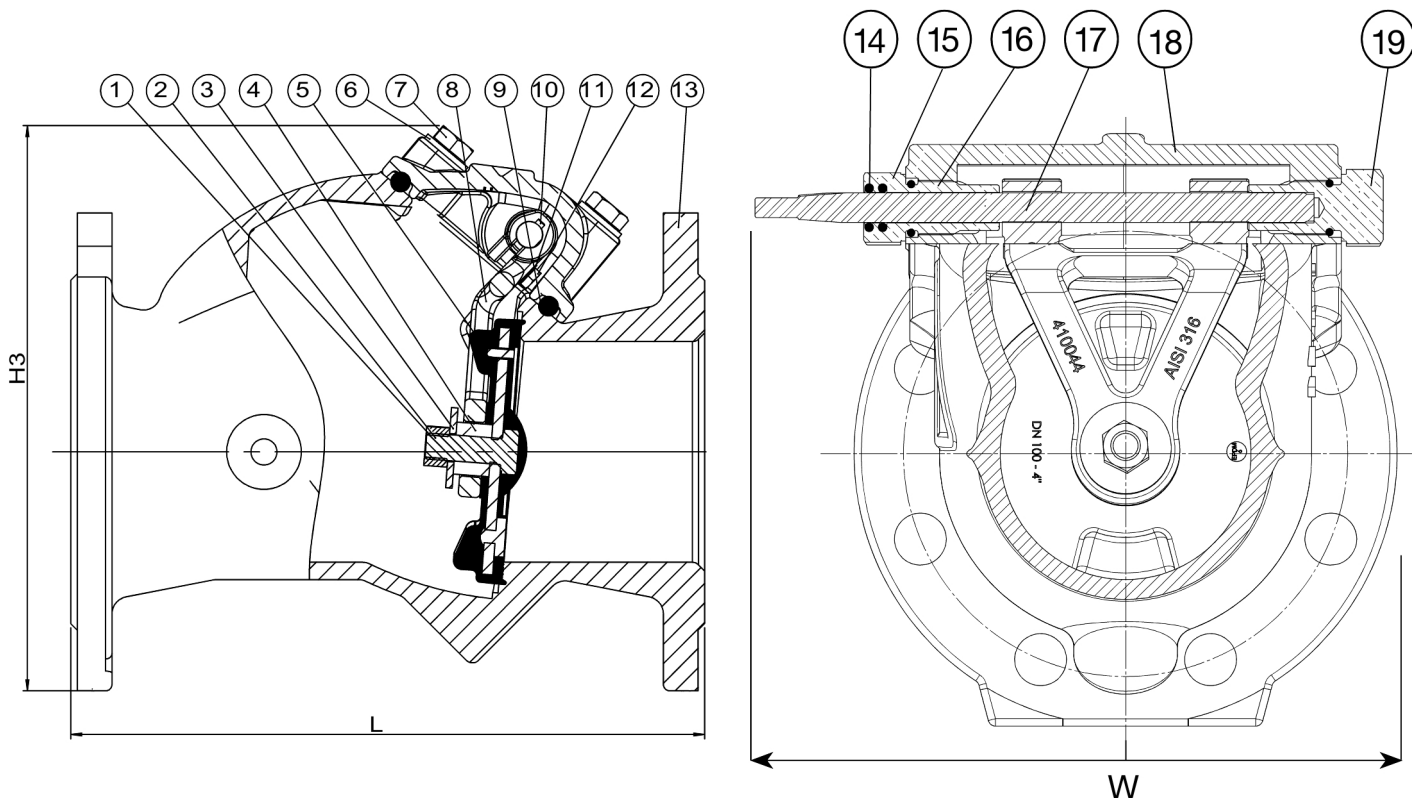

Component list:

1. Nut	Stainless steel A4	11. Washer	Stainless steel A4
2. Bolt	Stainless steel A4	12. Bolt	Stainless steel A4
3. Washer	Stainless steel A4	13. Body	Ductile iron GJS-500-7 (GGG-50)
4. Spacer	Polyamide	14. O-ring	NBR rubber
5. Disc ⁽¹⁾	Steel S235JR /EPDM	15. Bushing, open	Brass DZR
6. Washer	Stainless steel A2	16. O-ring	NBR rubber
7. Bolt	Stainless steel A2	17. Shaft	Stainless steel AISI 420
8. Hinge ⁽²⁾	Stainless steel AISI 316	18. Bonnet	Ductile iron GJS-500-7 (GGG-50)
9. Bonnet gasket	EPDM rubber	19. Bushing, closed	Brass DZR
10. Key	Stainless steel A4		

Components may be substituted with equivalent or higher class materials without prior notification.

1) DN50: Bronze/EPDM, DN250-300: Ductile iron/EPDM

2) DN ≥250: Ductile iron

Reference nos. and dimensions:

AVK ref. no.	DN mm	Flange drilling	L mm	H3 mm	W mm	Theoretical weight/kg
41-050-60-018	50	PN10/16	200	197	235	13
41-065-60-018	65	PN10/16	240	222	235	16
41-080-60-018	80	PN10/16	260	230	240	20
41-100-60-018	100	PN10/16	300	255	260	21
41-125-60-018	125	PN10/16	350	341	332	36
41-150-60-018	150	PN10/16	400	348	338	51
41-200-60-008	200	PN10	500	412	393	83
41-200-60-018	200	PN16	500	412	393	83
41-250-60-008	250	PN10	600	568	689	183
41-250-60-018	250	PN16	600	568	689	183
41-300-60-008	300	PN10	700	640	689	231
41-300-60-018	300	PN16	700	640	689	231

The designs, materials and specifications shown are subject to change without notice due to the continuous development of our product range.