



AVK GATE VALVE, FLANGED, OS&Y, 250 PSI/17.2 BAR

45/56-001

PN10/16 drilling, UL/FM approved, rising stem and handwheel, red, DN50, 250-400

AVK gate valves are designed with built-in safety in every detail. The wedge is fully vulcanized with AVK's own drinking water approved EPDM rubber compound. It features an outstanding durability due to the ability of the rubber to regain its original shape, the double bonding vulcanization process and the sturdy wedge design. The triple safety stuffing box sealing system, the high strength stem and the thorough corrosion protection safeguard the unmatched reliability.

Product description:

Flanged gate valve with rising stem and handwheel, UL/FM approved. For fire protection applications to max. 70° C

Standards:

- Designed according to AWWA C509, Designed according to FM 1120/1130, UL 262
- Face-to-face dimension according to ANSI B16.10
- Standard flange drilling to EN1092-2 (ISO 7005-2), PN10/16

Test/Approvals:

- Hydraulic tests according to FM and UL Standards.
- Seat: 1.5 x PN (in Bar). Body: 2 x PN (in Bar). Closing torque test.
- FM Approved. UL listed.

Features:

- Fixed, integral wedge nut prevents vibration and ensures durability
- Wedge fully vulcanized with drinking water approved EPDM rubber and equipped with wedge shoes to provide smooth operation
- Large conical stem hole in the wedge prevents stagnant water
- Wedge and body guide rails ensure stable operation
- Stem of copper alloy (DN50-250), Above sizes is alu bronze
- Full circle thrust collar provides fixation of the stem and low free running torques
- Triple safety stem sealing with an NBR wiper ring, a polyamide bearing with four NBR O-rings, and an EPDM rubber manchette
- Round EPDM bonnet gasket fixed in a recess
- Countersunk and sealed stainless steel bonnet bolts encircled by the bonnet gasket
- Full bore
- Low operating torque
- Fusion bonded epoxy coating in compliance with DIN 3476 part 1 and EN 14901

Accessories:

Supervisory switch



Expect ... **AVK**

The designs, materials and specifications shown are subject to change without notice. This is due to the continuous development of our product programme.

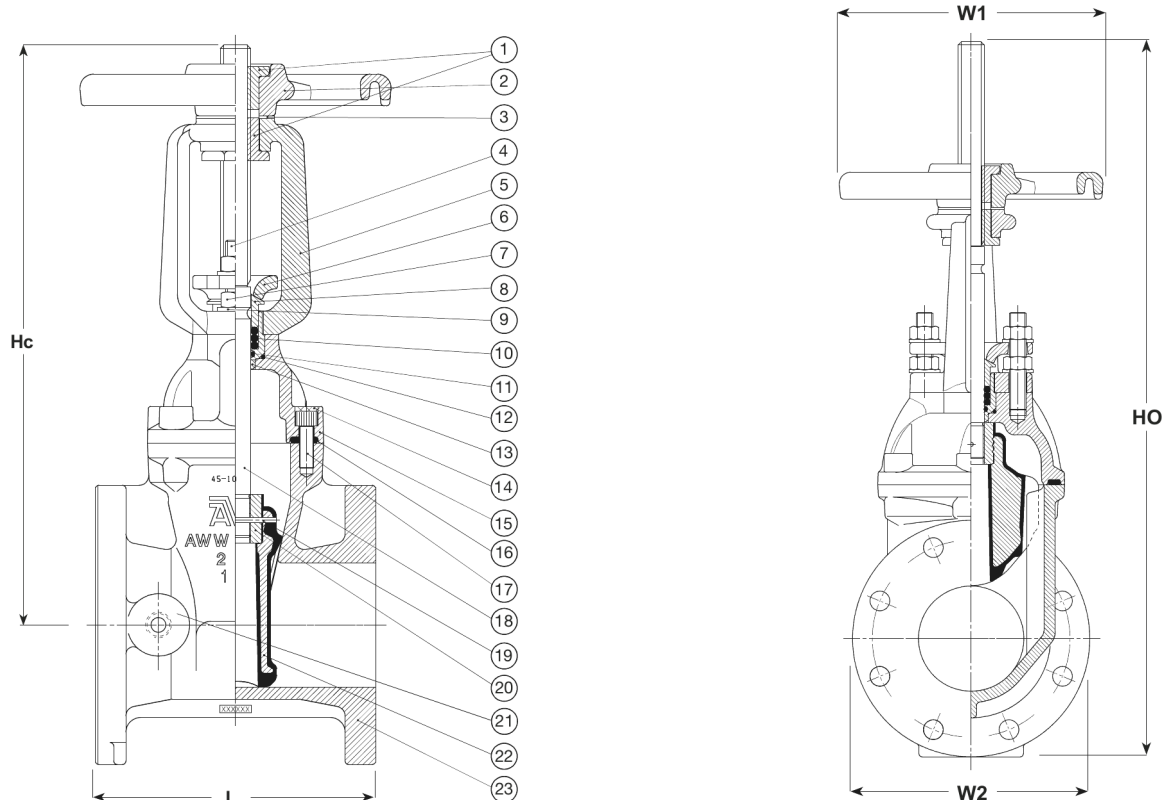

Component list:

1. Stem nut	ECO BRASS, DZR CW724R	13. Bushing	Polyamide
2. Handwheel	Cast iron	14. Seal	Hot melt glue
3. Thrust washer	Gunmetal bronze	15. Bonnet	Ductile iron
4. Stud bolt	Stainless steel A4	16. Bonnet gasket	NBR rubber
5. Yoke	Ductile iron	17. Bonnet bolt	Stainless steel A4
6. Gland follower	Ductile iron	18. Stem ⁽¹⁾	Copper alloy
7. Nut	Stainless steel A4	19. Pin	Stainless steel A2
8. Gland	Polyamide	20. Wedge nut	Brass, DZR CW626N
9. Washer	Stainless steel A4	21. Boss	Ductile iron, EPDM encapsulated
10. Stem seal O-ring	SBR rubber	22. Wedge	Ductile iron, EPDM encapsulated
11. O-ring	NBR rubber	23. Body	Ductile iron
12. O-ring	NBR rubber		

Components may be substituted with equivalent or higher class materials without prior notification.
 1) DN300-400: Alu-bronze C63020

Reference nos. and dimensions:

AVK ref. no.	DN	Flange	L	HC	HO	W1	W2	Turns	Theoretical
	mm	drilling	mm	mm	mm	mm	mm	to open	weight/kg
45-050-56-01614020	50	PN10/16	169	400	450	180	165	14	19
45-250-56-006B4020	250	PN10	330	935	1189	432	406	44	158
45-250-56-016B4020	250	PN16	330	935	1189	432	406	44	158
45-300-5C-006B4020 ⁽¹⁾	300	PN10	356	1054	1359	432	483	44	239
45-300-5C-016B4020 ⁽¹⁾	300	PN16	356	1054	1359	432	483	44	239
45-350-5C-016B4020 ⁽¹⁾	350	PN16	381	1384	1795	640	533	58	290
45-400-5C-006B4020 ⁽¹⁾	400	PN10	406	1385	2113	640	597	62	310
45-400-5C-016B4020 ⁽¹⁾	400	PN16	406	1385	2113	640	597	62	310

⁽¹⁾ Stem in aluminium bronze. 200 PSI/14 bar