



AVK KNIFE GATE VALVE, PN10

702/40-103

Double acting pneumatic actuator, replaceable top packing gland, DN50-600

AVK lug/wafer knife gate valves are bi-directional with full and plane bore. The protected sealings and high quality materials bring about a great performance and a long service life. AVK knife gate valves are available with lever, non-rising stem and handwheel, rising stem and handwheel, pneumatic actuator, ISO top flange for actuator or complete with electric actuator.

Product description:

Knife gate valve with pneumatic double-acting actuator for wastewater treatment 0°C to +80°C

Standards:

- Face-to-face dimension according to DIN/EN 558-1, series 20 (K1), up to and incl. DN 350
- Standard flange drilling to EN1092-2 (ISO 7005-2), PN10/16

Features:

- Replaceable top packing gland enables sealing replacement without disassembly of the valve
- The valve is self cleaning as particles will be pushed off the gate when opening the valve. For extra protection of the packing gland a scraper is available as an optional extra.
- Bi-directional, can be installed independent of the flow direction
- Full bore with no reduction of the flow
- Plane bottom prevents sediment from being accumulated
- No cavity in the body and thus no risk of clogging
- U-shaped one-piece NBR sealing between the body parts makes up for tolerances in coating and casting. It is reinforced with a steel insert to protect it from being damaged during operation.
- Encaged stem with yokes prepared for mounting of micro switches and inductive sensors
- Stem and gate connection is secured with self-locking nuts
- Supports integrated in the body casting protect the gate from deflecting under pressure
- Body of ductile iron with 100-150 µm UV resistant polyester coating, RAL 5017. Optionally of acid-resistant stainless steel or duplex
- Yokes of carbon steel with coating 100-150 µm of plascoat PPA 571 Aqua
- Gate, stem, bolts and nuts of acid-resistant stainless steel
- Washers under the bolts protect the coating
- Slim design and low weight
- Approved according to the 97/23/CE European Pressure Equipment Directive
- Approved according to the 94/9/94EC, ATEX Directive
- Available in larger dimensions
- Optionally in higher PN class

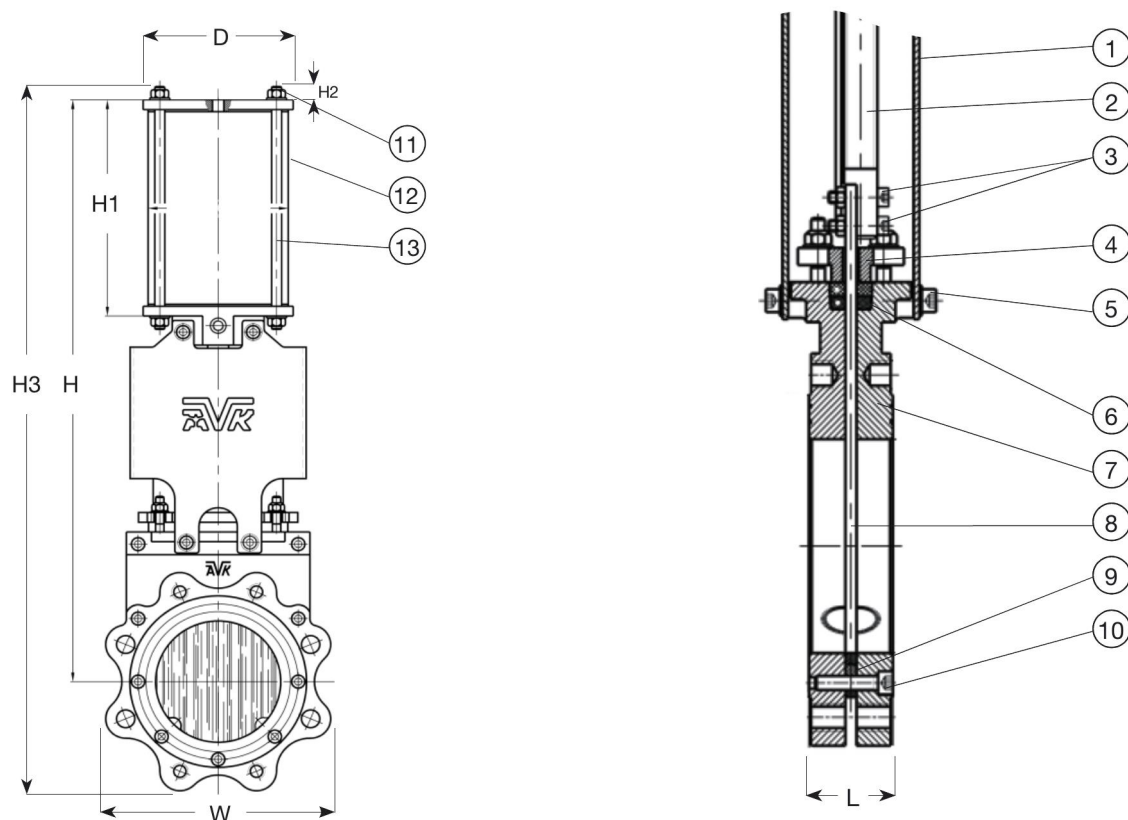

Expect ... **AVR**

Component list:

1. Plate	Carbon steel	8. Gate	Stainless steel 316
2. Stem	Stainless steel 316	9. U-shaped seal	Steel / NBR
3. Bolt	Stainless steel A4	10. Bolt	Stainless steel A4
4. Top packing gland	Ductile iron GJS-400-15 (GGG-40)	11. Nut	Stainless steel A4
5. Bolt	Stainless steel A4	12. Pneumatic actuator	Aluminium
6. Packing	NBR + PTFE	13. Rod	Carbon steel
7. Body	Ductile iron GJS-400-15 (GGG-40)		

Components may be substituted with equivalent or higher class materials without prior notification.

Reference nos. and dimensions:

AVK ref. no.	DN	Flange	L	H	H1	H2	H3	W	D	Test pressure	Working	Theoretical
	mm	drilling	mm	mm	mm	mm	mm	mm	mm	bar	Pressure bar	weight/kg
702-0050-10-0000123	50	PN10	43	415	147	14	494	130	80	15	10	7.9
702-0065-10-0000123	65	PN10	46	456	160	14	541	143	80	15	10	9.5
702-0080-10-0000121	80	PN10	46	486	177	14	592	183	100	15	10	13
702-0100-10-0000130	100	PN10	52	549	197	14	664	202	100	15	10	16
702-0125-10-0000134	125	PN10	56	610	232	16	740	229	125	15	10	22
702-0150-10-0000135	150	PN10	56	691	267	16	840	267	160	15	10	33
702-0200-10-0000019	200	PN10	60	871	327	19	1053	326	190	15	10	52
702-0250-10-0000019	250	PN10	68	1046	375	19	1263	395	190	15	10	71
702-0300-10-0000018	300	PN10	78	1217	428	19	1462	451	190	15	10	93
702-0350-10-0000019	350	PN10	78	1381	499	25	1666	518	250	9	6	153
702-0400-10-0000012	400	PN10	90	1541	549	25	1854	576	250	9	6	185
702-0450-10-0000017	450	PN10	90	1715	594	25	2049	618	300	6	4	271
702-0500-10-0000011	500	PN10	95	1875	656	25	2249	698	300	6	4	326
702-0600-10-0000011	600	PN10	105	2169	756	25	2602	817	300	6	4	441