

Description

Plastic handlever with 9 notched positions.



Construction

1	Nut	Galvanised steel
2	Washer	Galvanised steel
3 / 7	Bolts	Galvanised steel
4	Notch Plate	DIN 17100 1.0037/ FZV
5	Lever	PA6.6 and 30% Glass fiber
6	Name plate	PA6.6 and 30% Glass fiber
8	Washer	Galvanised steel
9	Insert	Sinter Metal
10	Bearing	POM
11	Spiral pin	DIN 7343 ST/FZV
12	Spring	DIN 17100 1.0037/ FZV
13	Latch	DIN 17100 1.0037/ FZV
14	Grip	PA6.6 and 30% Glass fiber

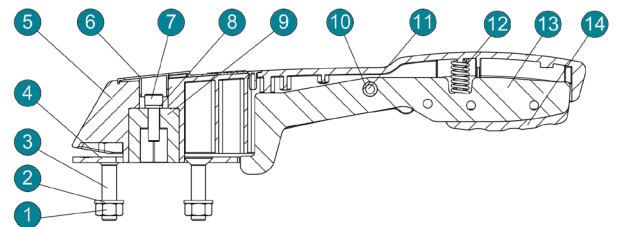

Type code

HLP . F07 11 . 240K

① ② ③ ④

① Actuator type	HLP	Plastic handlever
② Mounting face for valve	F05 - F07	according to EN ISO5211
③ Shaft square	[mm]	Dimension of shaft connection
④ Handlever length	[mm]	

Dimensions

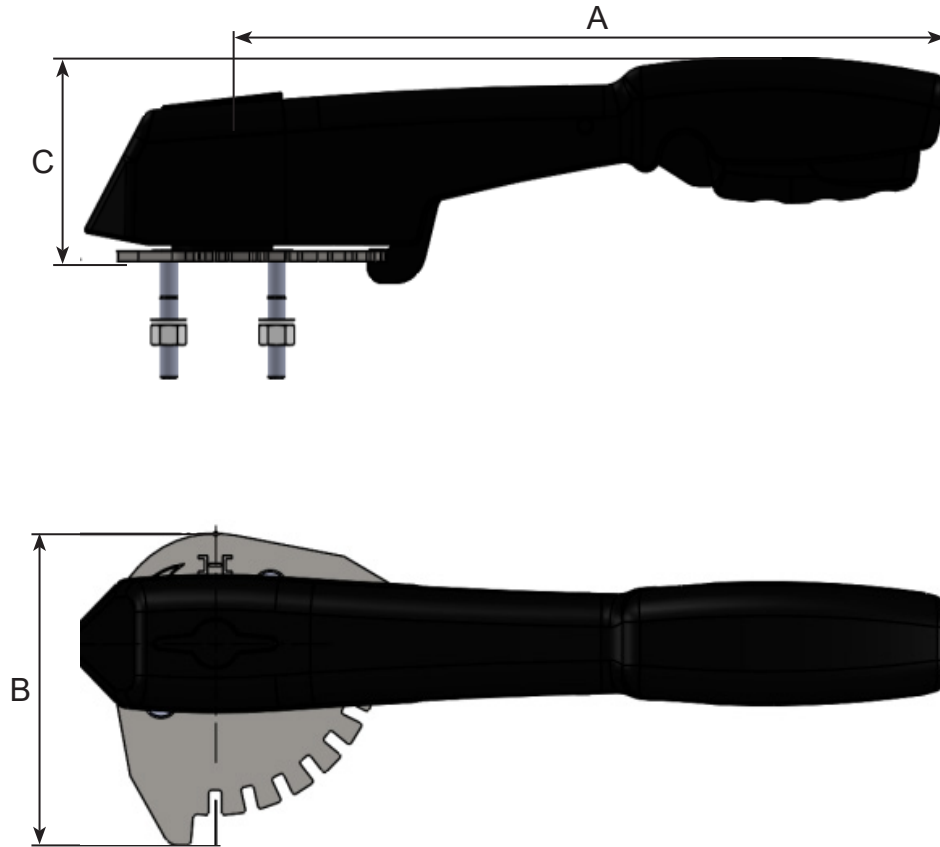

Handlever type	A [mm]	B [mm]	C [mm]	[kg]
HLP.F0511.240K	240	99	61	0.4
HLP.F0711.240K	240	109	61	0.4
HLP.F0714.390K	390	109	66	0.6
HLP.F0717.390K	390	109	66	0.6