

**Introduction**

This instruction defines the assembly process for **HLA-C1** hand levers.

**Assembly**

Components

1	Cap
2	Screw with captive washer
3	Washer / Extension*
4	Screw
5	Antifriction washer stuck to handle
6	Screws
7	Notch plate
8	Nuts
9	Hand lever

\*In Desponia plus, the washer is replaced for an extension.

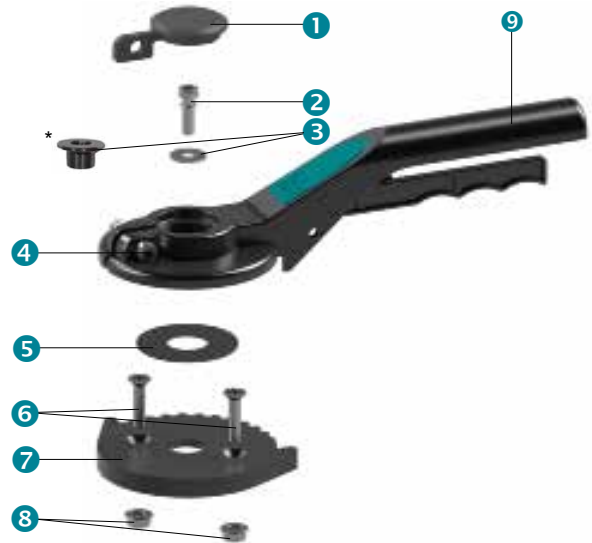

**Step 1:**

Align C (closing position) with valve body. Place notch plate (7) on top of valve flange.



**Step 2:**

Place screws (6) into the drills of the notch plate (7).



**Step 3:**

Place nuts (8) on the screws (6) and tighten (see the torque table below).



**Step 4:**

Ensure antifriction washer (5) is placed on handle.



**Step 5:**  
Place hand lever on the shaft, lower the lever as far as it will go and adjust position until it locks onto a tooth of the notch plate.



**Step 6:**  
Place the screw (2) and washer without extension (3) on the upper part of the hand lever and tighten until the screw touches the washer, then retighten by 90°.



**Step 6\*:**  
For Desponia plus place the screw (2) and extension without washer (3) on the upper part of the hand lever and tighten until the screw touches the washer, then retighten by 90°.



**Step 7:**  
Tighten hand lever lateral screw (see the torque table).



**Step 8:**  
Tighten the top screw (2) of the hand lever (see the torque table).



**Step 9:**  
Close hand lever cover (1).



### Torques

Hand lever type	2 Screw		4 Screw		6 Screws	
	size	Torque (Nm)	size	Torque (Nm)	size	Torque (Nm)
HLA.F0508.210-C1	M4 / M6	1.7 / 6	M6	6	M6	6
HLA.F0511.210-C1					M8	10
HLA.F0708.210-C1						
HLA.F0711.210-C1	M6	6	M8	14.5	M8	10
HLA.F0711.340-C1						
HLA.F0714.340-C1						
HLA.F0717.340-C1						



The technical data are noncommittal and do not assure you of any properties. Please refer to our general sales conditions. Modifications without notice.  
© 2024 InterApp AG, all rights reserved